

Where Do You Need Sound Isolation?



apartments & condominiums

ACOUSTICAL PERFORMANCE CRITERIA:
DESIGN REQUIREMENTS AND
GUIDELINES FOR SCHOOLS



ASTM E413-10
Classification for
Rating Sound
Insulation

ACOUSTIC DESIGN IN ARCHITECTURE



GSA Court
Facilities

ASTM E90-09
Sound transmission loss of
building partitions...



HOTELS & MOTELS—GROUP R

Healthcare



ANSI S12-60—SOUND TRANSMISSION CLASS
US PATENT PENDING



ACTIVAR
INC.

Construction Products Group

www.activarcpg.com

NEW—SOUND-RATED ACCESS PANEL—THE STC SERIES



JL Industries Introduces the First STC-Rated Access Panel with an STC 47 Rating
Meet Noise Containment and Sound Transmission Blocking Requirements for Walls with the
US Patent Pending STC Panel

TESTED & LABELLED BY
INTERTEK WARNOCK HERSEY
TO MAINTAIN AN STC VALUE OF 47
WHEN INSTALLED AS DIRECTED
IN AN STC-RATED WALL



STC-1212NLBG

Heavy-Duty EPDM Rubber
Gasketing & Proprietary
Sound-Blocking Insulation

SPECIFICATIONS:

Frame: 16 gauge CRS with 1" Flange

Door: 2 1/4" thick with heavy duty, continuous hinge

Insulation: Proprietary sound-blocking assembly

Finish: Powder coat gray primer. Other colors optional

Latch/Lock: Compression Paddle Latch(es)

Sizes: Minimum 12" x 12", Maximum 24" x 36"

Options:

Locking Black Flush Paddle Latch, or Zinc-Plated

Stainless Steel Construction-16 ga Frame, 20 ga Door

Galvanneal Steel Construction- 16 ga Frame, 20 ga Door



Learning Spaces; LEED IEQ Enhanced
 Acoustical Performance Credits for
 Schools / ANSI S12-60.

Healthcare; HIPAA Requirements for
 Patient Privacy

Judicial Setting; Meet GSA Acoustic
 Isolation Standards.

Group R Occupancies; Sound Isolation
 Between Units.

TESTED IN ACCORDANCE WITH:

ASTM E90-09

Sound Transmission Loss of Building Partitions

CLASSIFIED IN ACCORDANCE WITH:

ASTM E413-10 Classification for Rating Sound Insulation
of Partitions or Floors

ASTM E1332-10a Standard Classification for Rating Out-
door-Indoor Sound Attenuation

Model Size is Door Size			Latch(es)
Model & Size W X H (inches)	Wall Opening Dimension	Approx. Weight	
STC-1212	12 3/8 x 12 3/8	14	1
STC-1414	14 3/8 x 14 3/8	18	1
STC-1616	16 3/8 x 16 3/8	23	1
STC-1818	18 3/8 x 18 3/8	29	1
STC-2030	20 3/8 x 30 3/8	53	2
STC-2222	22 3/8 x 22 3/8	40	1
STC-2230	22 3/8 x 30 3/8	53	2
STC-2236	22 3/8 x 36 3/8	55	2
STC-2424	24 3/8 x 24 3/8	46	1
STC-2430	24 3/8 x 30 3/8	54	2
STC-2436	24 3/8 x 36 3/8	60	2

Common Sizes Shown Above,
 Custom Sizes Also Available up to 24" x 36"
 In 1/4" Increments

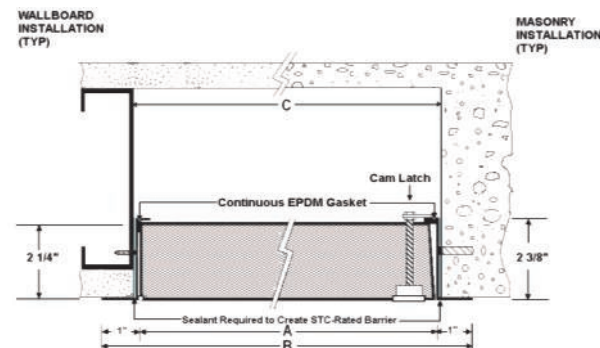

1-800-554-6077
 SALES@ACTIVARCPG.COM

ACTIVAR
 INC.
 Construction Products Group
 www.activarcpg.com



ACTIVARCPG.COM/JL-INDUSTRIES